

EX. 1097
1/2

BW

From: Bob Winters bobw@chadwickwinters.com
Subject: Re: Question re: City GIS and T&W data reliability
Date: November 3, 2021 at 7:02 AM
To: shane miller shane_miller_usa@yahoo.com

I can only comment on the steep slope function of the City's GIS. My experience is that the GIS data is derived from the best available information. However, if a steep slope determination is made without benefit of an accurate and current ground topographic survey, such determination can't be defended.

Sent from my T-Mobile 5G Device
Get [Outlook for Android](#)

From: shane miller <shane_miller_usa@yahoo.com>
Sent: Tuesday, November 2, 2021 6:02:10 PM
To: Bob Winters <bobw@chadwickwinters.com>
Subject: Re: Question re: City GIS and T&W data reliability

2 of 2:



EX. 1097 2/2

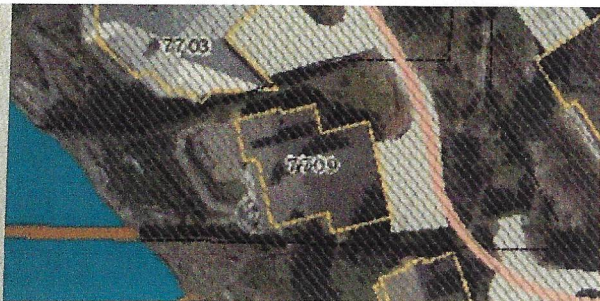

These maps are for the use of City of Mercer Island staff for the purposes of permit application evaluation. It provides a general assessment of known or suspect hazard areas for which the City will require site and project specific evaluation by a Washington State licensed engineer, geologist or engineering geologist prior to issuing a site for development. All areas have not specifically evaluated for hazards and there may be locations that are not correctly represented on these maps. It is the responsibility of the property owners and map users to evaluate risk associated with their proposed development. No site-specific assessment of risk is implied or otherwise indicated by the City of Mercer Island by these maps.

Sent from my iPhone

On Nov 2, 2021, at 5:10 PM, Bob Winters <bobw@chadwickwinters.com> wrote:

I can't comment without knowing what the data is that's provided by Troost and Wisher, how it's derived, and what it's compared against for the assessment of reliability.

Sent from my T-Mobile 5G Device
Get [Outlook for Android](#)

From: Shane Miller <shane_miller_usa@yahoo.com>
Sent: Tuesday, November 2, 2021 2:16:15 PM
To: Bob Winters <bobw@chadwickwinters.com>
Subject: Question re: City GIS and T&W data reliability

Hi Bob,

If a Staff Employee from the Building Division of a City Municipality were to say the following,

"The City's GIS system incorporates data provided by Troost & Wisher to estimate which hazards likely to be present. Over 12 years of continuous use, this mapping data as proven reliable when compared to sub grade investigations provided to the City during permit applications"

What would be your take or response to this statement?

Thank you,
Shane Miller
(206) 910-8443